



Email Continuity Service

The best of class even in the worst of times.

Natural disasters. Service disruptions. Routine maintenance. Lots of things can take your servers down, but your email doesn't have to go with it. Our new Email Continuity Service is always on, simple to use and affordable for businesses of all sizes. Best of all, it's an effective

Causes of Email Downtime

Planned Email Outages

- Email platform upgrade or migration
- Data center or office move
- Planned power outage
- System maintenance
- Required patch management
- Disaster recovery testing

Unplanned Email Outages

- Connectivity losses
- Data center office move
- Planned power outage
- System maintenance
- Required patch management
- Disaster recovery testing

Benefits

- Simple to launch, easy to use
- No onsite hardware or software required
- Affordable for businesses of all sizes
- Always on, instantly available
- No "bounced" messages

On-Premise Online (Working)

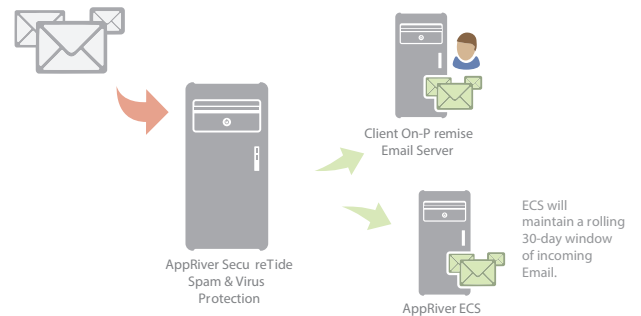

On-Premise Offline (Outage)

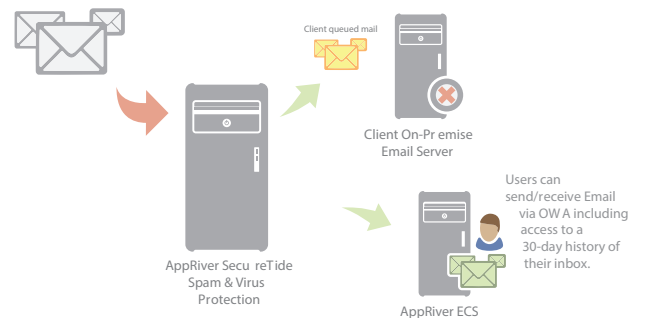

On-Premise Online (Restored)

